



Wendy Worthington
079 017 3022
wendy.w@harcourts.co.za

Contact Harcourts Dunn

021 8212237

134 Edward Road
Belville
CapeTown
7550

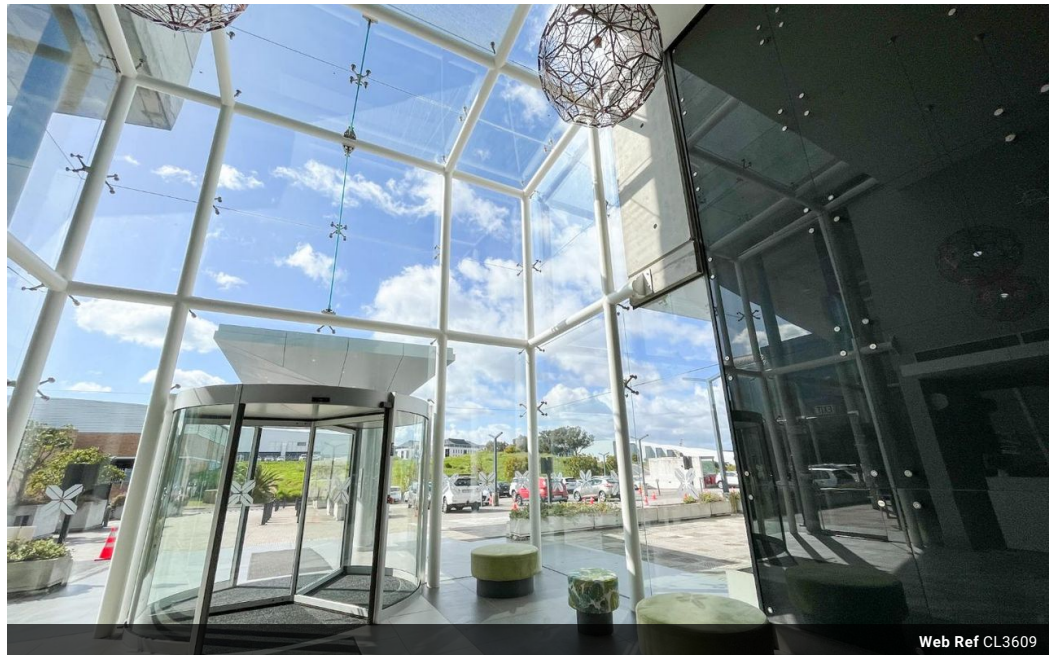

Web Ref CL3609



R220 per m²

Gross Monthly Rental R101,200 Excl. VAT

 20  0

MODERN OFFICE TO LET IN GLACIER PLACE, TYGERVALLEY

NOW AVAILABLE! **

****Premium Property Alert**** - Discover this contemporary 9-storey award-winning building located in the highly desirable Tyger Valley Precinct, making it an ideal business address.

Conveniently positioned near public transport and a wealth of amenities, including Virgin Active and Tyger Valley Centre, this property offers both accessibility and convenience. Glacier Place boasts a 4-star green rating and features state-of-the-art finishes, complemented by an impressive parking capacity of 686 bays.

Enjoy peace of mind with 24/7 access-controlled security stationed in the lobby of this prestigious building. The office space available is situated on the ground floor, occupying a corner position with expansive glass windows facing Carl Cronje Drive.

Features

Zoning Commercial

Exterior
Basement Parkings 20

Sizes
Floor Size 460m²

